

S^c Carolina
 96 District
 Pursuant to a warrant from John Thomas
 Esq. Com^r of Locations for the S^c Side of the State
 Dated the 24th of May 1791. I have admeasured and laid out
 unto Joseph Griffith a Tract of Forty acres of Land in the
 waters of Cannons Creek a small Branch of ~~Cannons~~ Broad
 River and hath such Shape Marks (Beetings & Boundings) as
 the above plat Represents.—
 Surveyed by me the 16th June 1791
 Tho^s Waters D.S.

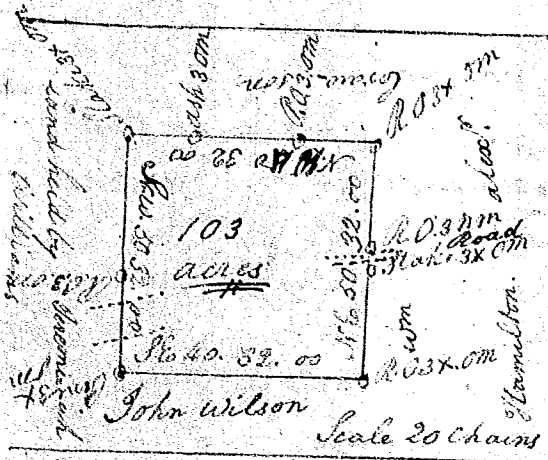

S^c Carolina.
 Pursuant to a warrant from
 John Thomas Esq. Com^r of Locations
 in Ninety Six District I admeasured
 and laid out unto Jeremiah
 Williams a tract of One hundred
 and three acres of Land situate
 in Newberry County on the drains
 of Williams branch the waters of
 Broad River I hath such count
 aries Beetings form and Marks as the above plat doth
 Represent Surveyed this 14th Nov^r 1791

Go. Harbert D.S.

Date of warrant 2th Nov^r 1791